

## Installation Operation and Maintenance Manual

### INLINE & 'T' BRANCH FILTERS F12, F14, F16, F22 & F24



**THIS DOCUMENT** is only applicable to the service of Inline and 'T' branch filters. General instructions regarding installation, operation and maintenance for all types of filters must be read prior.

## **FILTER SERVICE INSTRUCTIONS.**

These instructions are confined to the replacement of the Element and O-Ring seal only. Any damage caused to other components would require the units return to the manufacturer.

Before undertaking any servicing of the filter, ensure the filter is completely isolated from the supply and outlet pressures, and any pressure in the filter has been removed.

Before commencing the filter refurbishment, it is recommended that the filter be removed from the line and worked on in a clean environment.

Cleanliness during assembly is most important, particularly on all sealing surfaces.

## **BEFORE SERVICE, REFER TO THE BPMV GENERAL INSTRUCTIONS**

### **DISMANTLING**

1. Unscrew the Filter Casing '1' from the Body '7'.
2. Unscrew the Retaining Bolt '2' and remove the Filter Element '4' and Retaining Washer '3'
3. Remove the Body O-ring '5'.
4. Check all components for damage, corrosion or wear. Damaged, corroded or worn components should not be used.

**NOTE:** Item 6 is bonded to the filter body and cannot be removed.

### **REASSEMBLY**

1. Fit the O-ring '5' to the Filter Body '7'.
2. Fit the Filter Element '4' and Retaining Washer '3'. to the Pillar Bolt '6' and Secure with the Bolt '2'
3. Re-assemble the Filter Casing '1'.
4. Check the Filter unit for leakage when pressure is reapplied

**NOTE:** Ensure lubricants are compatible with the system medium.

## INLINE FILTER EXPLODED VIEW

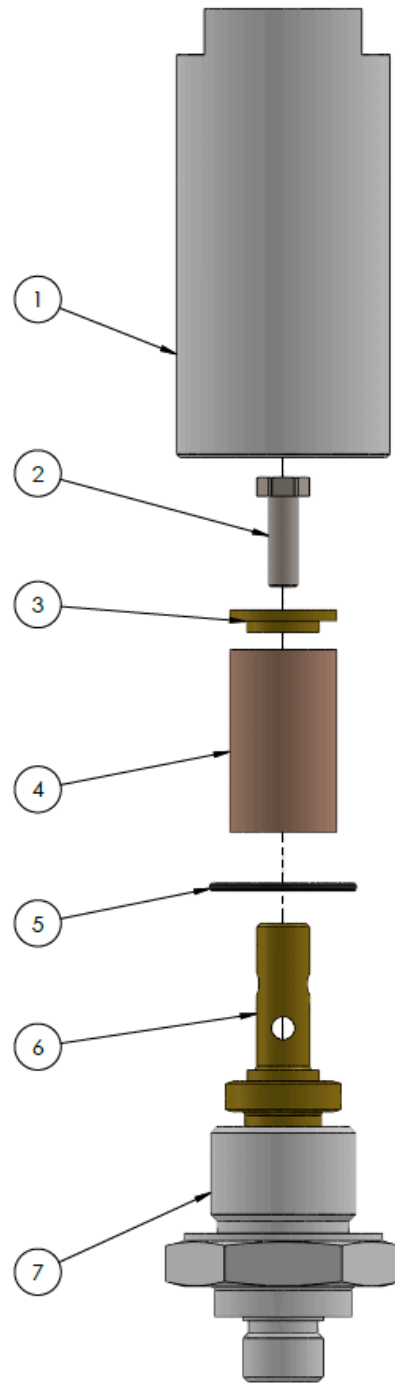

### RECOMMENDED SPARES KIT

#### INLINE STANDARD FILTER

ITEM	DESCRIPTION	QUANTITY
4	Filter Element	1
5	O-Ring	1

## 'T' BRANCH FILTER EXPLODED VIEW

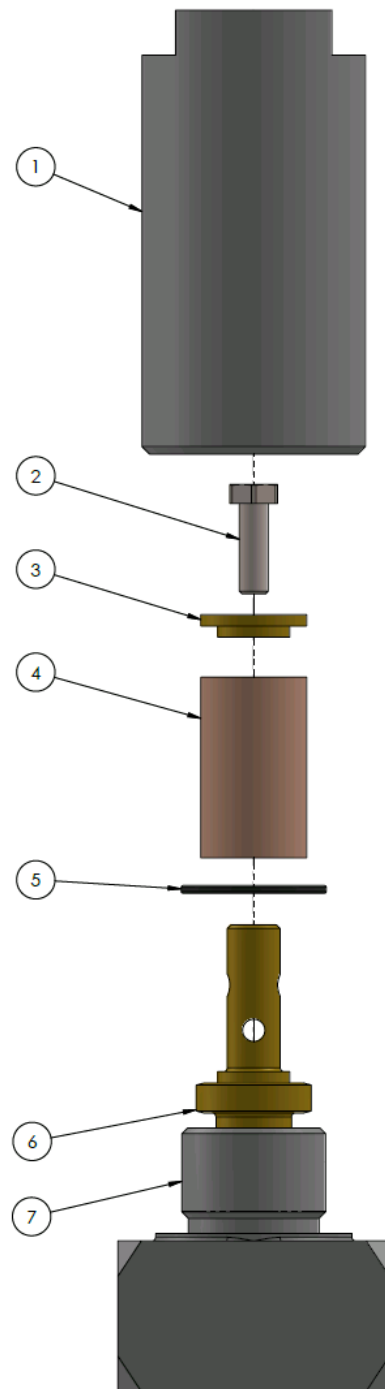

### RECOMMENDED SPARES KIT

#### 'T' BRANCH STANDARD FILTER

ITEM	DESCRIPTION	QUANTITY
4	Filter Element	1
5	O-Ring	1