

DATASHEET

BACK PRESSURE MAINTAINING VALVE (BPMV): H130 AND H131

MODEL CODE							
H130 -	1	1	AA	300P	N	NY	0

MODEL TYPE	
H130 -	DOME LOADED INTERNALLY
H131 -	DOME LOADED EXTERNALLY

MAXIMUM INLET PRESSURE	
1	1,000 psi (70 Bar)

SET PRESSURE RANGE	
1	0.75 - 1,000 psi (0.05 - 70 Bar)

MATERIAL	
AA	ALUMINIUM ALLOY
SS	STAINLESS STEEL
AB	ALUMINIUM BRONZE
BR	BRASS

GAUGE PORT	
0	NO PORT
GB	1/4" BSPP INLET & OUTLET

SEAT MATERIAL	
NY	NYLON

SEALS	
N	NITRILE
V	VITON

PORTING	
300P	3" BSPP
300N	3" NPT

SPECIFICATION

- ORIFICE: 50.8mm
- MEDIUM: H130 - GAS ONLY
- MEDIUM: H131 - GAS AND LIQUID
- DRY WEIGHT: 47 kg (104 lb) (ALUMINIUM ALLOY)

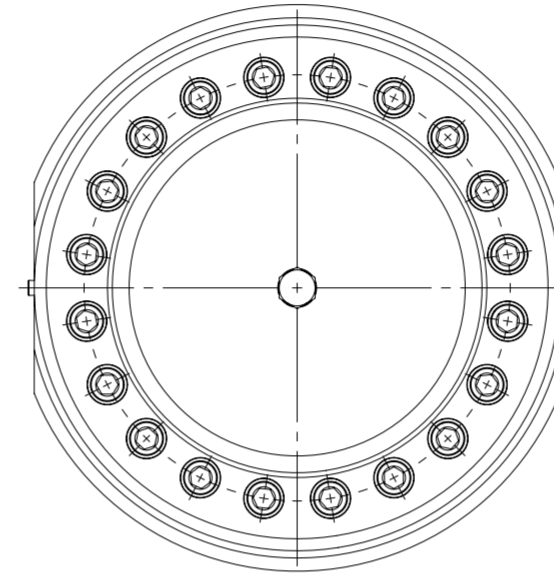
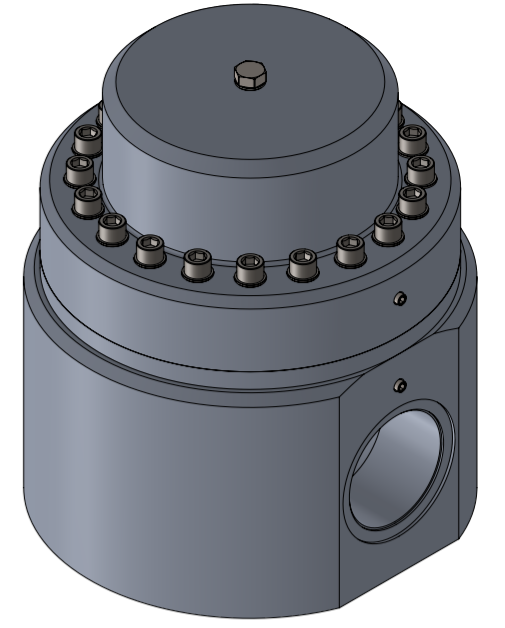

THE VALVE IS DESIGNED FOR USE AT A MAXIMUM PRESSURE OF 70 Bar BUT IS **NOT** CE MARKED. WHEN USED IN THE UK AND EU THE MAXIMUM PRESSURE IS DEPENDENT ON THE FLUID GROUP AS DEFINED BY THE PRESSURE EQUIPMENT DIRECTIVE AS FOLLOWS:
 GROUP 1 LIQUIDS - 26 Bar
 GROUP 2 LIQUIDS - 70 Bar
 GROUP 1 GASES - NOT SUITABLE
 GROUP 2 GASES - 13 Bar

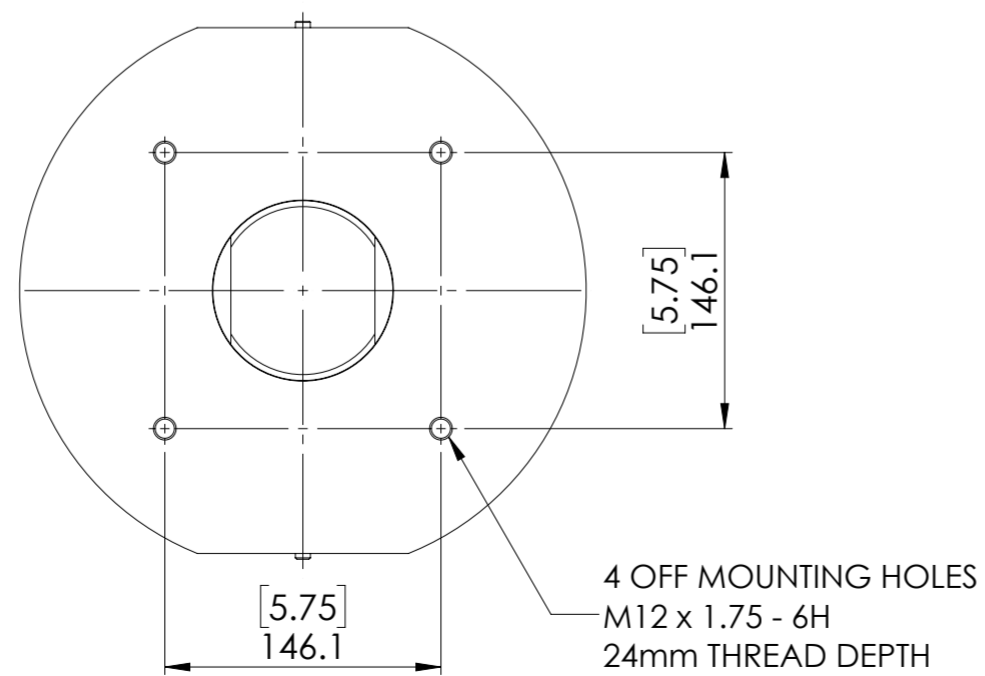
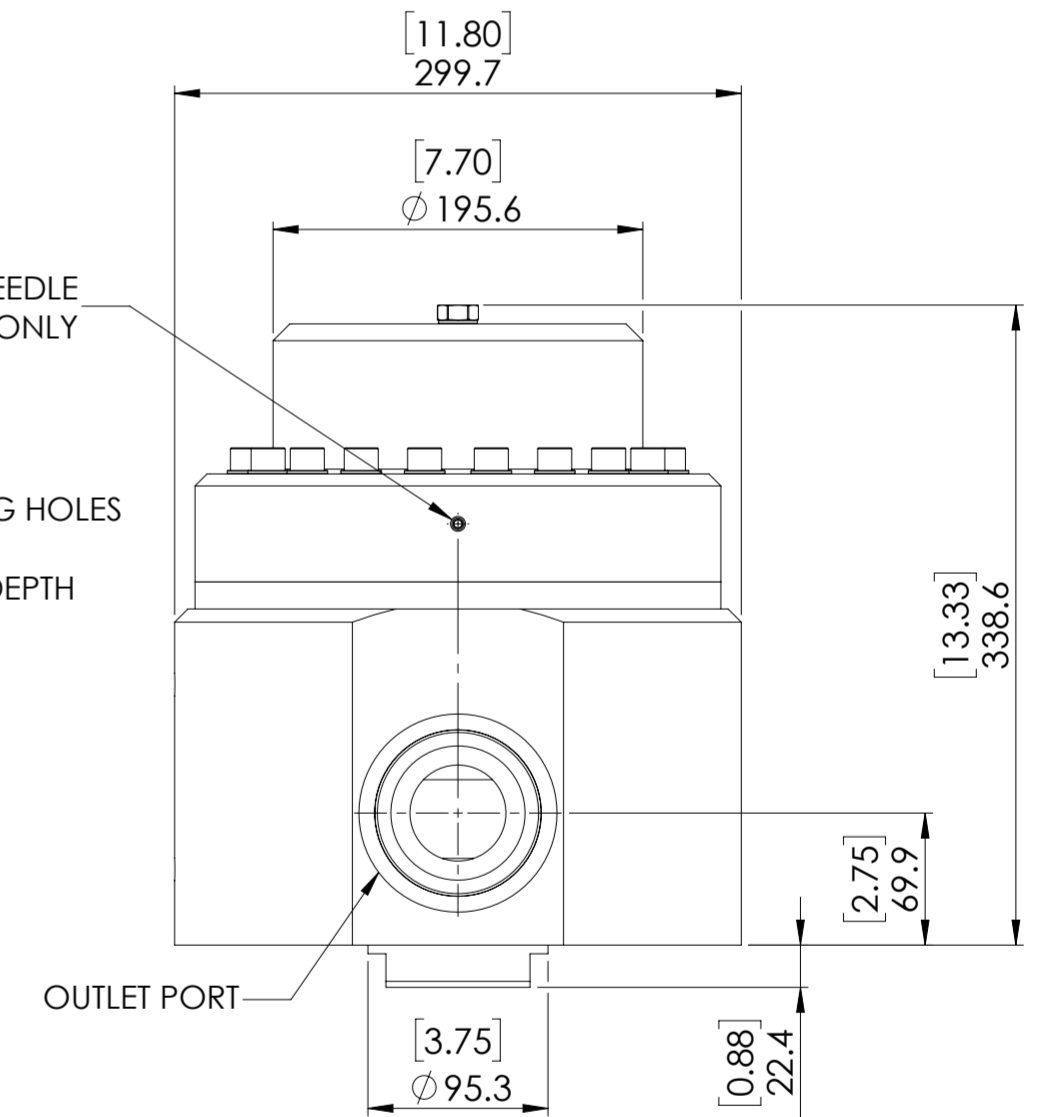
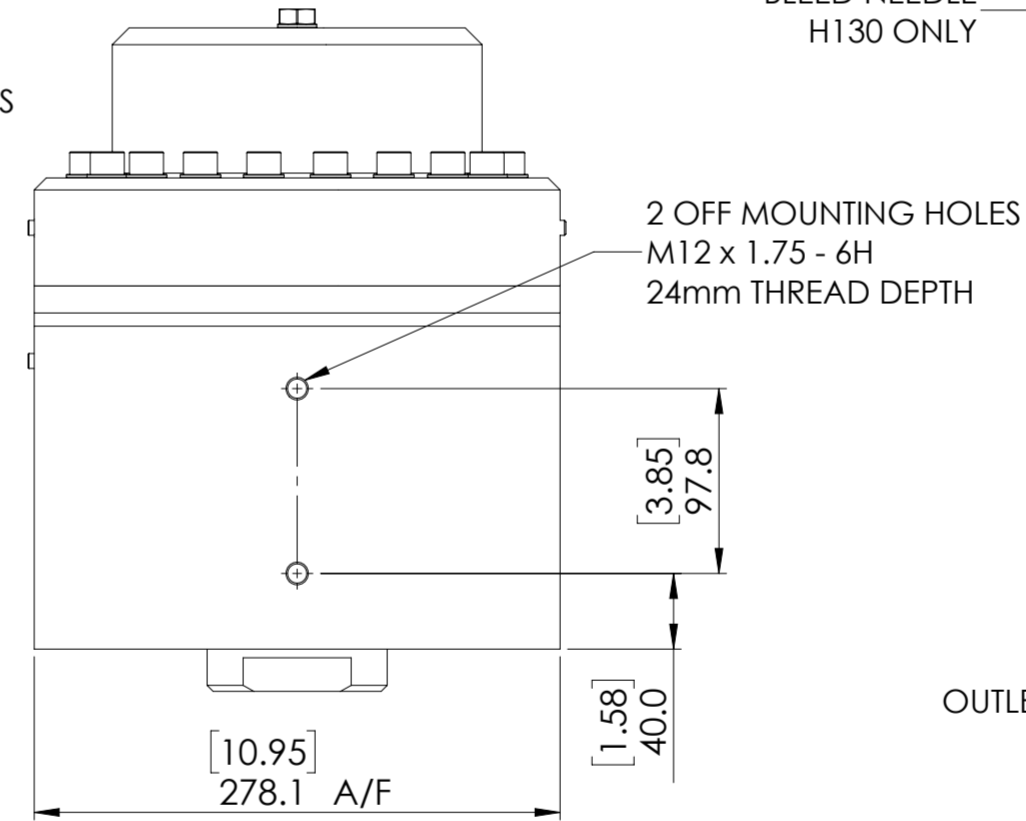
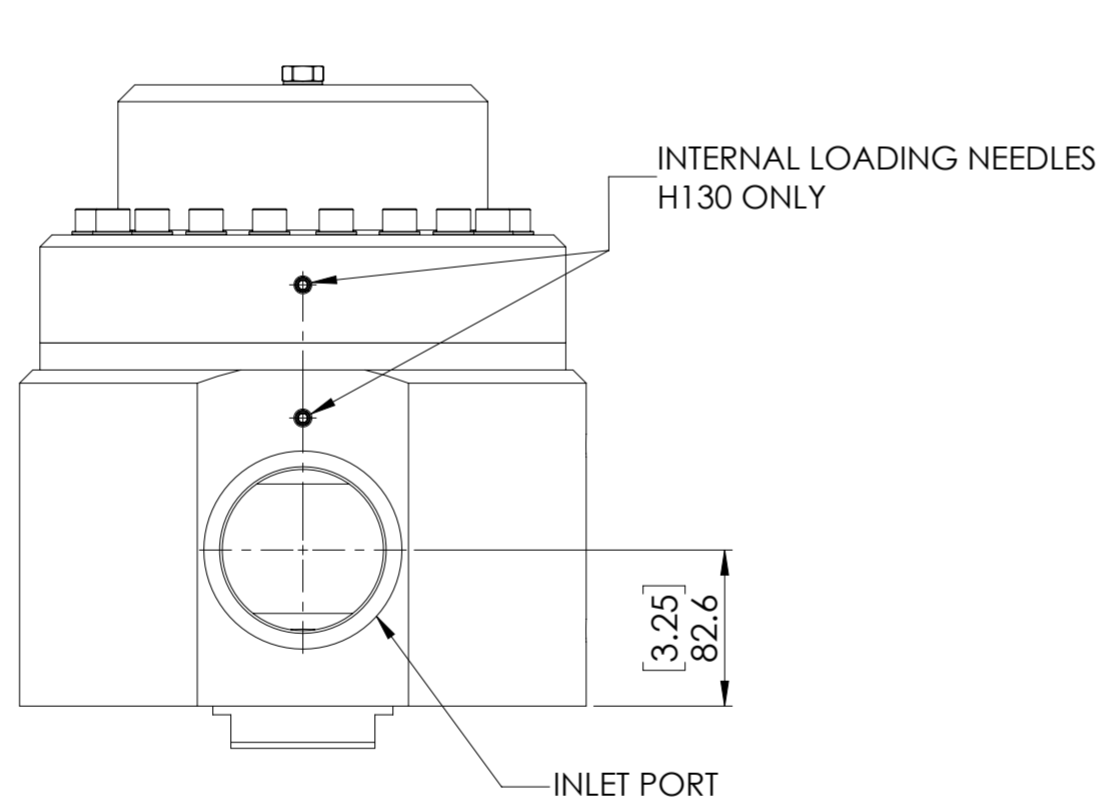
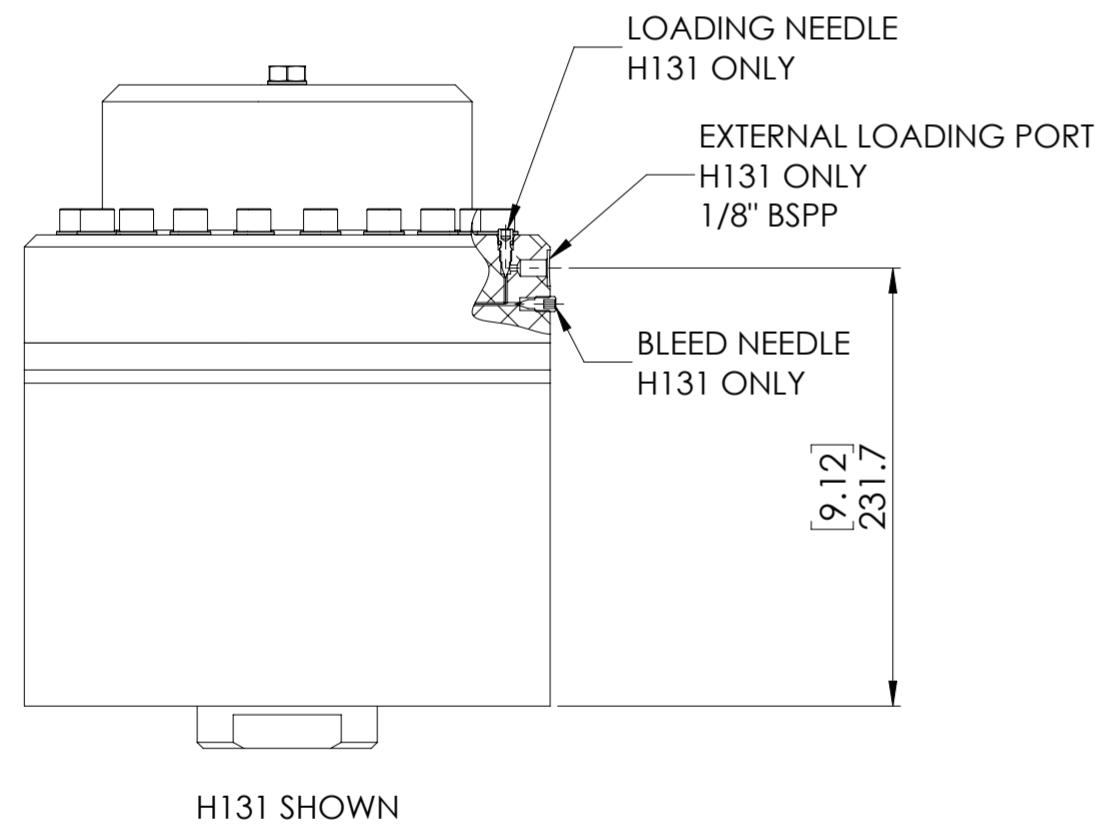

© AND DESIGN RIGHT Bis Wells LTD. ALL RIGHTS RESERVED. WITHOUT THE PRIOR WRITTEN PERMISSION OF Bis Wells Ltd NO PART OF THIS DOCUMENT MAY BE ALTERED, ADAPTED, PUBLISHED, REPRODUCED OR TRANSMITTED IN ANY FORM OR MEDIUM.				UNLESS OTHERWISE SPECIFIED, DIMENSIONS ARE IN MILLIMETRES. ALTERNATE DIMENSIONS IN SQUARE BRACKETS ARE IN INCHES.						
DRAWN	N.DANIEL	SHEET	1 OF 1	3RD ANGLE PROJECTION	DRAWING SIZE	A2	DRAWING SCALE	1:4	DRAWING NUMBER	DS0021
DATE	29/11/19	ISSUE	2							